

# Hydraulic Toe Jacks

V / V-EX / G / U



# Hydraulic Toe Jacks

## V/V-EX/G/U

GKS-PERFEKT hydraulic toe jacks are a specialized jack for lifting loads with low clearance, and can be used in a variety of applications. The adjustable toe and extended feet on our toe jack gives it more stability and flexibility than a standard jack. Our engineering philosophy is simple: less parts, less problems. The less moving parts there are, the less problems that will occur during the life of the product. Given all of this, along with the testing that is done on every jack before leaving our factory, our hydraulic toe jacks are not only functional, but also long-lasting—an investment that will pay over time.

### FEATURES

- Extremely low loading height, starting from 0.6 inches
- Simplified Design—less parts, less problems
- Test mark ANSI/ASME
- Height adjustable, die-forged safety toe
- Precision guideways
- Wheels for easy transport
- Lifetime technical support

### V5 Hydraulic Toe Jack

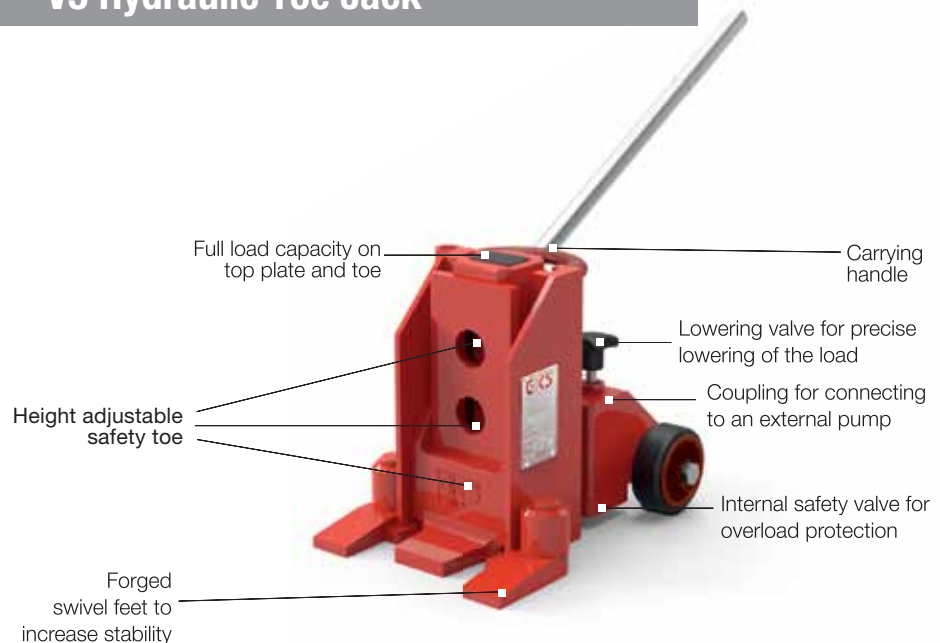



## Toe Jack V5

### Features:

- Forged, steel safety toe, which is stronger than the industry standard of cast steel
- A peg on the back of the toe that secures correct insertion
- Same loading capacity on the toe and the head
- 3 starting positions



### Technical data

	V5
Item number	1-10181
Full load capacity	11,000 lbs. / 50kN (5 t)
Working pressure	7,542 psi / 520 bar
Minimum loading height using safety toe	0.6" / 15 mm
Lifting height	5.5" / 140 mm
Adjustable range of safety toe	3 x
Loading height using top plate	10" / 252 mm
Overall dimensions (L x W x H)	11.2 x 9.3 x 10" / 285 x 235 x 252 mm
Tare weight with oil fill	46 lbs. / 21 kg

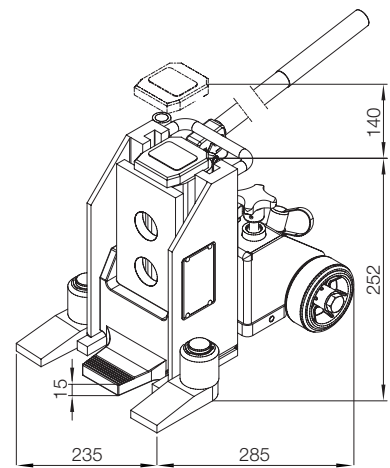



## Toe Jack V10

### Features:

- Forged, steel safety toe, which is stronger than the industry standard of cast steel
- Swivel feet to increase stability
- Same loading capacity on the toe and the head
- 4 starting positions



### Technical data

#### V10

Item number	1-10182
Full load capacity	22,000 lbs. / 100kN (10 t)
Working pressure	7,542 psi / 520 bar
Minimum loading height using safety toe	0.8" / 20 mm
Lifting height	6.3" / 160 mm
Adjustable range of safety toe	4 x
Loading height using top plate	12.2" / 310 mm
Overall dimensions (L x W x H)	14 x 10.2 x 12.2" / 357 x 260 x 310 mm
Tare weight with oil fill	71 lbs. / 32 kg

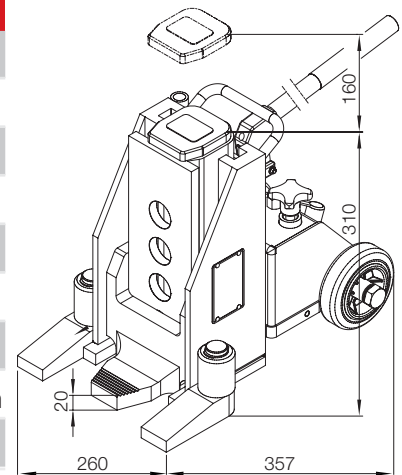



## Toe Jack V15

### Features:

- Forged, steel safety toe, which is stronger than the industry standard of cast steel
- Ability to operate manually or with a hydraulic pump
- Same loading capacity on the toe and the head
- 4 starting positions



### Technical data

### V15

Item number	1-10183
Full load capacity	33,000 lbs. / 150kN (10 t)
Working pressure	7,542 psi / 520 bar
Minimum loading height using safety toe	1" / 25 mm
Lifting height	6.3" / 160 mm
Adjustable range of safety toe	4 x
Loading height using top plate	12.5" / 318 mm
Overall dimensions (L x W x H)	15.7 x 12.6 x 12.5" / 399 x 320 x 318 mm
Tare weight with oil fill	117 lbs. / 53 kg

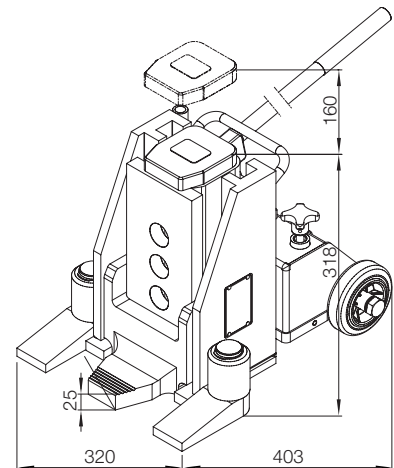





## Toe Jack V20

### Features:

- Forged, steel safety toe, which is stronger than the industry standard of cast steel
- Fast stroke and slow stroke cylinders to facilitate manual lifting operation
- Ability to operate manually or with a hydraulic pump
- 3 starting positions



### Technical data

#### V20

Item number	1-10184
Full load capacity	44,000 lbs. / 200kN (20 t)
Working pressure	7,542 psi / 520 bar
Minimum loading height using safety toe	1.2" / 30 mm
Lifting height	6.3" / 160 mm
Adjustable range of safety toe	3 x
Loading height using top plate	12.8" / 325 mm
Overall dimensions (L x W x H)	16.7 x 12.8 x 12.8" / 425 x 326 x 325 mm
Tare weight with oil fill	159 lbs. / 72 kg

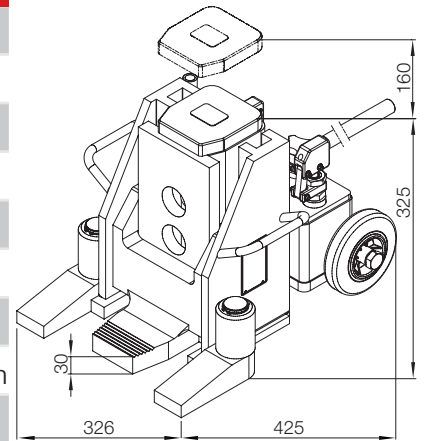



## Toe Jack V30-EX

### Features:

- Built without internal hydraulics to reduce the weight and size of the jack
- Designed for applications with difficult to access spaces or where a safety distance from the load is required
- Same loading capacity on the toe and the head
- 2 starting positions



### Technical data

#### V30-EX

Item number	1-11140
Full load capacity	66,000 lbs. / 300 kN (30 t)
Working pressure	6,237 psi / 430 bar
Minimum loading height using safety toe	1.6" / 40 mm
Lifting height	6.1" / 156 mm
Adjustable range of safety toe	2 x
Loading height using top plate	13" / 330 mm
Overall dimensions (L x W x H)	17.9x15.7 x 13" / 454 x 400 x 330 mm
Tare weight	232 lbs. / 105 kg

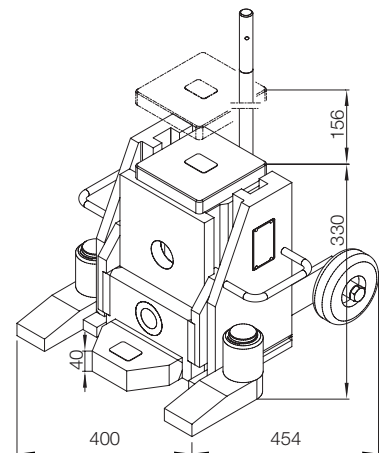



## Toe Jack G5

### Features:

- Specially designed for maintenance purposes on fork lift trucks and other industrial vehicles
- Outstanding stability due to solid feet and an extended grooved safety toe
- 3 starting positions



### Technical data

	G5
Item number	1-10189
Full load capacity	11,000 lbs. / 50 kN (5 t)
Working pressure	7,542 psi / 520 bar
Minimum loading height using safety toe	1.2" / 30 mm
Lifting height	5.5" / 140 mm
Adjustable range of safety toe	3 x
Loading height using top plate	10.4" / 265 mm
Overall dimensions (L x W x H)	15.6x10x10.4" / 397x 255 x265 mm
Tare weight with oil fill	66 lbs. / 30 kg

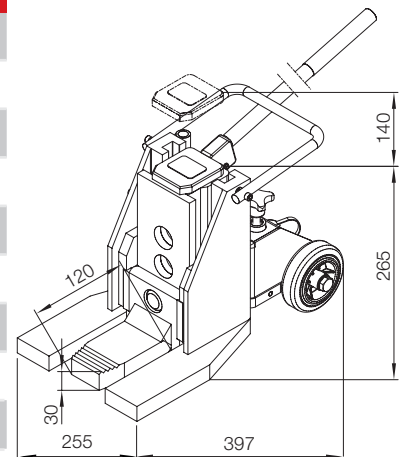





## Toe Jack G10

### Features:

- Specially designed for maintenance purposes on fork lift trucks and other industrial vehicles
- Outstanding stability due to solid feet and an extended grooved safety toe
- 3 starting positions



### Technical data

#### G10

Item number	1-12378
Full load capacity	22,000 lbs. / 100 kN (10 t)
Working pressure	7,542 psi / 520 bar
Minimum loading height using safety toe	1.4" / 35 mm
Lifting height	5.5" / 140 mm
Adjustable range of safety toe	3 x
Loading height using top plate	12.5" / 318 mm
Overall dimensions (L x W x H)	18.1 x 11 x 12.5" / 461 x 280 x 318 mm
Tare weight with oil fill	127 lbs. / 57 kg

